

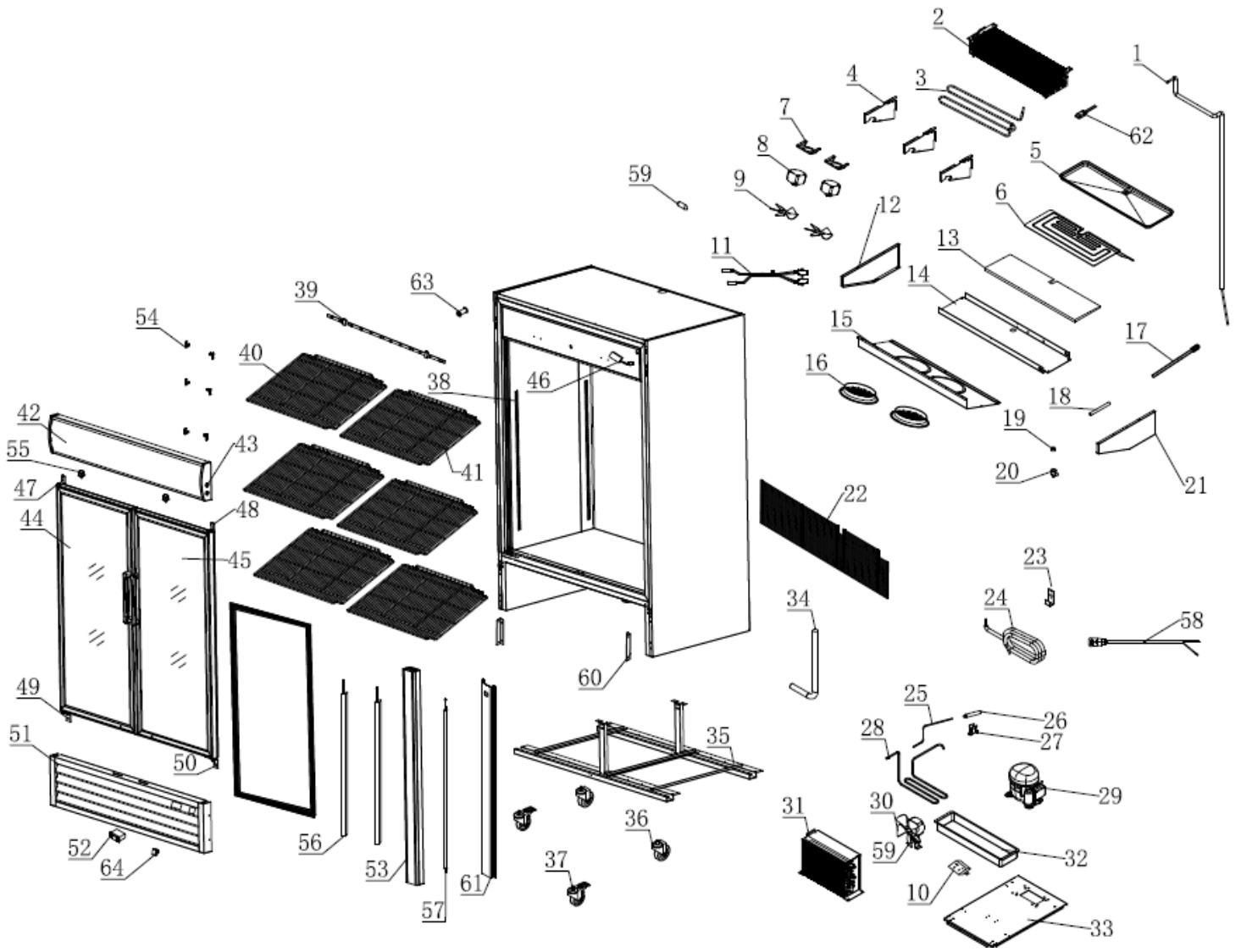

# GDF1200

## Exploded parts diagram

Sliding door image shown with reference to parts for the hinged versions



| Part Number     | Number | Description                | Qty |
|-----------------|--------|----------------------------|-----|
| B9-GDFCAP02     | 1      | Capillary c/w Suction Pipe | 1   |
| B9-GDFEVAP02    | 2      | Evaporator                 | 1   |
| B9-GDFHEATER03  | 3      | Defrost heater             | 1   |
| ***             | 4      | Baffle Plate               | 3   |
| B9-GDFTRAY02    | 5      | Evap Drip Tray             | 1   |
| B9-GDFHEATER04  | 6      | Evap Drip Tray Heater      | 1   |
| ***             | 7      | Evap Fan Fixing Plate      | 2   |
| B9-GDFEVAPFAN   | 8      | Evaporator Fan Motor       | 2   |
| B9-GDFEVAPBLADE | 9      | Evaporator Fan Blade       | 2   |
| B9-GDFRELAY02   | 10     | Relay                      | 1   |
| B9-GDFSENSOR    | 11     | Temperature Sensor         | 1   |
| ***             | 12     | Plate                      | 1   |
| ***             | 13     | Insulation                 | 1   |
| ***             | 14     | Fan Casing Back            | 1   |
| ***             | 15     | Fan Casing Front           | 1   |
| ***             | 16     | Fan Guard                  | 2   |
| B9-GDFDRAINHEAT | 17     | Drain Heater               | 1   |
| ***             | 18     | Drainpipe                  | 1   |
| B9-GDFSPIGOT    | 19     | Drain Spigot               | 1   |
| B9-GDFSPIGNUT   | 20     | Drain Spigot Nut           | 1   |
| ***             | 21     | Plate                      | 1   |
| ***             | 22     | Rear Grille                | 1   |
| ***             | 23     | Pipe Fixing                | 1   |
| ***             | 24     | Suction Pipe               | 1   |
| ***             | 25     | Pipework                   | 1   |
| ***             | 26     | Drier                      | 1   |
| ***             | 27     | Drier Bracket              | 1   |
| ***             | 28     | Discharge Pipework         | 1   |
| B9-GDFCOMP02    | 29     | Compressor                 | 1   |
| B9-GDFCONDBLADE | 30     | Condenser Fan Blade        | 1   |
| B9-GDFCOND      | 31     | Condenser                  | 1   |
| B9-GDFVAPTRAY02 | 32     | Vaporising Tray            | 1   |
| ***             | 33     | Unit Base                  | 1   |
| B9-GDFDRAIN     | 34     | Drainpipe                  | 1   |
| ***             | 35     | Mountings                  | 1   |
| B9-GDFCASTOR02  | 36     | Unbraked Castor            | 2   |
| B9-GDFCASTOR01  | 37     | Braked Castor              | 2   |
| ***             | 38     | Ladder Rack                | 8   |
| B9-GDFLED02     | 39     | Canopy LED                 | 1   |
| B9-GDFSHELF02   | 40     | Shelf LH                   | 4   |
| B9-GDFHELF03    | 41     | Shelf RH                   | 4   |
| B9-GDFCANOPY02  | 42     | Light Canopy               | 1   |

|                 |     |                                |    |
|-----------------|-----|--------------------------------|----|
| B9-GDFSWITCH01  | 43  | Light Switch (Red)             | 2  |
| B9-GDFDOOR02    | 44  | Door LH                        | 1  |
| B9-GDFDOOR01    | 45  | Door RH                        | 1  |
| B9-GDFDRIVER02  | 46  | LED Driver                     | 1  |
| B9-GDFHINGE03   | 47  | Top LH Hinge                   | 1  |
| B9-GDFHINGE01   | 48  | Top RH Hinge                   | 1  |
| B9-GDFHINGE04   | 49  | Bottom LH Hinge                | 1  |
| B9-GDFHINGE02   | 50  | Bottom RH Hinge                | 1  |
| B9-GDFPANEL02   | 51  | Front Grille Panel             | 1  |
| B9-GDFCONTROL   | 52  | Controller                     | 1  |
| ***             | 53  | Centre Mullion                 | 1  |
| K8-SHELFCLIPN   | 54  | Shelf Clips                    | 32 |
| B9-GDFFANSWITCH | 55  | Fan Switch                     | 2  |
| B9-GDFLED02     | 56  | Internal Side LED              | 2  |
| B9-GDFLED04     | 57  | Internal Centre LED            | 1  |
| ***             | 58  | Power cord                     | 1  |
| B9-GDFCONDFAN   | 59  | Condenser Fan Motor            | 1  |
| ***             | 60  | Fixing Bracket                 | 2  |
| ***             | 61  | Press Plate                    | 1  |
| B9-GDFLIMIT     | 62  | Heat Limit Protector (Defrost) | 1  |
| ***             | 63  | Pressure relief Valve          | 1  |
| B9-SWITCH       | 64  | Mains Switch                   | 1  |
| B9-GDFLOCK      | N/A | Lock c/w Key                   | 1  |

\*\*\* Please contact Spares for assistance \*\*\*